

ELECTRICAL:

CURRENT RATING: 0.75 AMP Max.
 VOLTAGE RATING: 500 VAC
 CONTACT RESISTANCE:
 < 30 milliohms Max. Initial, 20 milliohms After Test
 INSULATION RESISTANCE:
 > 1 Megaohm Min.
 DIELECTRIC WITHSTANDING VOLTAGE:
 500V (rms) AC for 1 Minute
 OPERATING TEMPERATURE: 0°C to +85°C

MATERIAL:

INSULATOR: High Temperature Thermoplastic, UL94V-0
 LATCHES: High Temperature Thermoplastic, UL94V-0
 CONTACT: Phosphor Bronze
 BOARDLOCK: SUS 304
 PLATING: Gold over 50u" (MIN.) Nickel in
 Contact Area and 100u" (MIN.) Matte - Tin
 Plating Over 50u" Nickel on Solder Tail

ENVIRONMENTAL:

OPERATING TEMPERATURE: 0°C To 85°C
 SOLDERABILITY: Passed Per JESD22-B102,
 Condition C.

VIBRATION: Passed Per EIA-364-28
 HUMIDITY: Passed Per EIA-364-31
 THERMAL SHOCK: Passed Per EIA-364-32
 MECHANICAL SHOCK: Passed Per EIA-364-27

MECHANICAL:

DURABILITY: 25 Cycles Min.
 INSERTION FORCE: 10.88 Kg Max
 CONTACT RETENTION FORCE: 500~1500 g Per Contact
 WITHDRAWAL FORCE: 0.3 Kg Min Per Contact

HOW TO ORDER:

B 0 3 7 - 2 8 8 X - 0 3 X X - X Z H F

NUMBER OF CONTACTS:

288

PC TAIL / CLIP DIMENSIONS

Option	"C"±0.25	"D"±0.25
0	2.10	3.57
1	2.40	3.57
2	2.70	3.57
3	3.10	4.27

EAR COLOR

- 0 - Black
- 1 - White
- 2 - Blue

HOUSING COLOR

- 1 - Black
- 2 - White
- 3 - Blue (284C)
- 4 - Blue (2935U)
- 5 - Green
- 6 - Blue (287C)
- 7 - Dark Grey (431C)
- 8 - Red (186C)

SELECTIVE GOLD PLATING

- A - Gold Flash/100m" Tin
- 0 - 10µ" Gold/100m" Tin
- 1 - 15µ" Gold/100m" Tin
- 2 - 30µ" Gold/100m" Tin

HALOGEN FREE

RoHS COMPLIANT

Rev	Description	Drawn	Checked	Approved	Date
0	Issued	B.S.	S.M.	S.M.	12/11/13
A	Revised Dimensions & Added PC Tail / ClipTable	B.S.	S.M.	S.M.	03/31/16
B	Revised Plating Options	B.S.	S.M.	S.M.	11/03/16

SMP TECHNOLOGY, INC.

DDR DIMM Socket, Vertical, 288 Position, Thru Hole, 1.2 Volt

SCALE: N/A

TOL. DEC. .X +/- 0.25 .XX +/- 0.20 .XXX +/- 0.15 ANGLE +/- 3° UNIT: mm

SERIES: B037-288X-03XX-XZHF

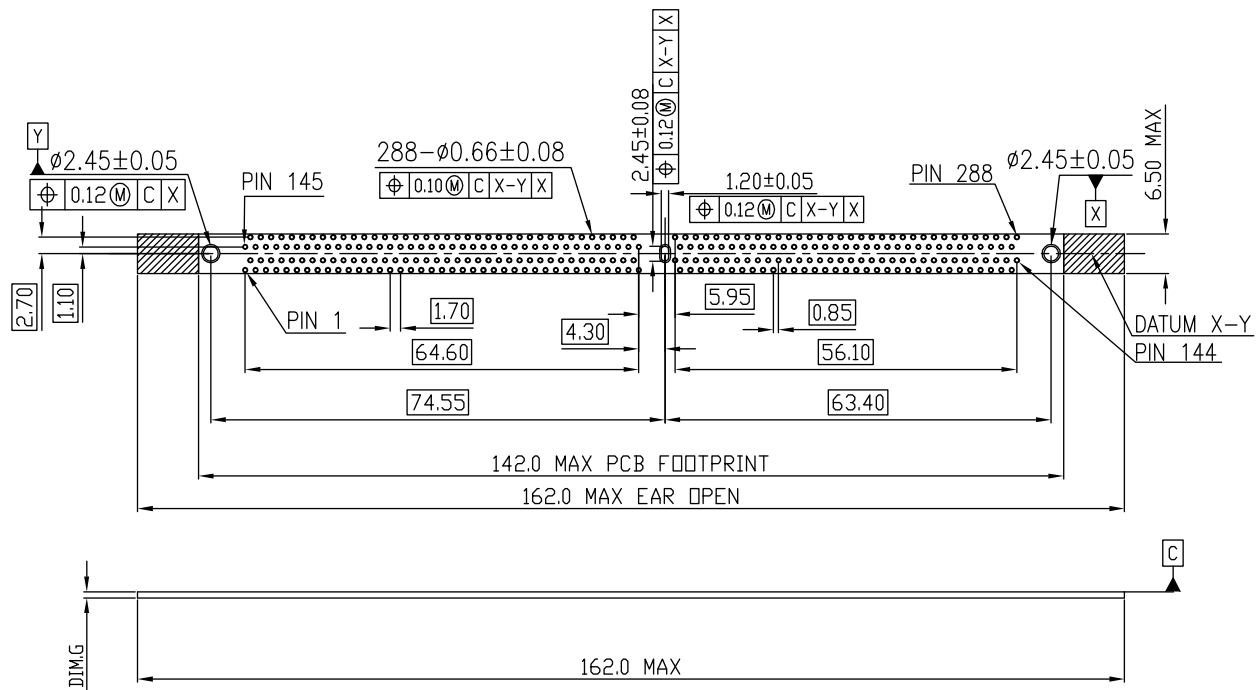

RECOMMENDED PC BOARD LAYOUT (TOP VIEW)

SMP TECHNOLOGY, INC.

DDR DIMM Socket, Vertical, 288 Position, Thru Hole, 1.2 Volt

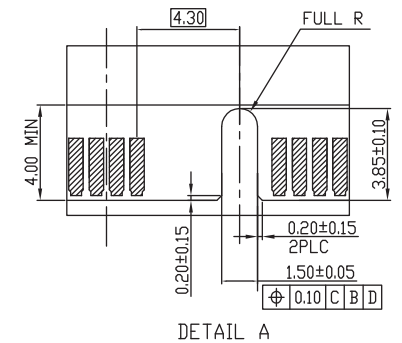
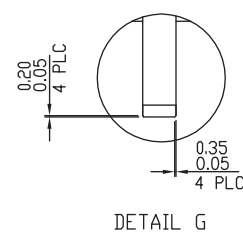
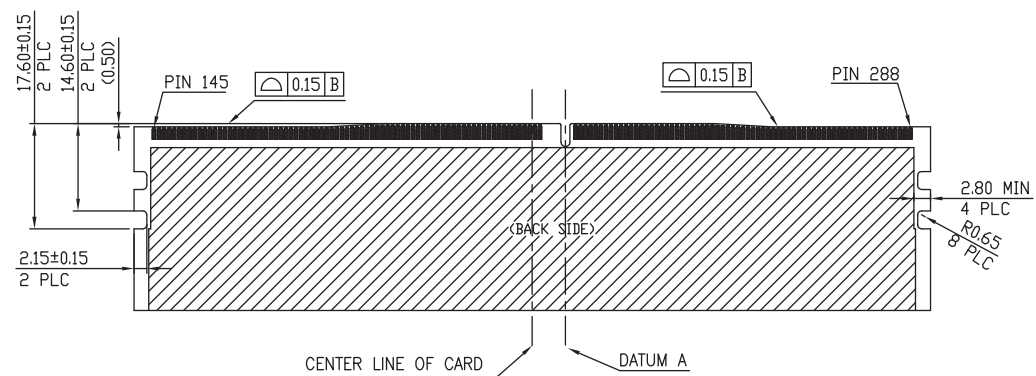
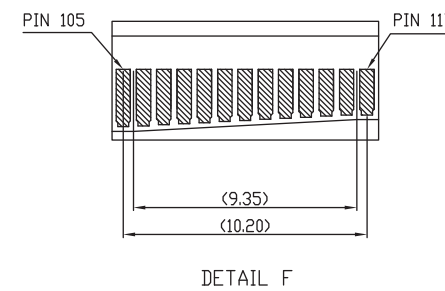
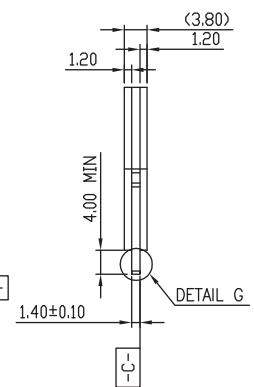
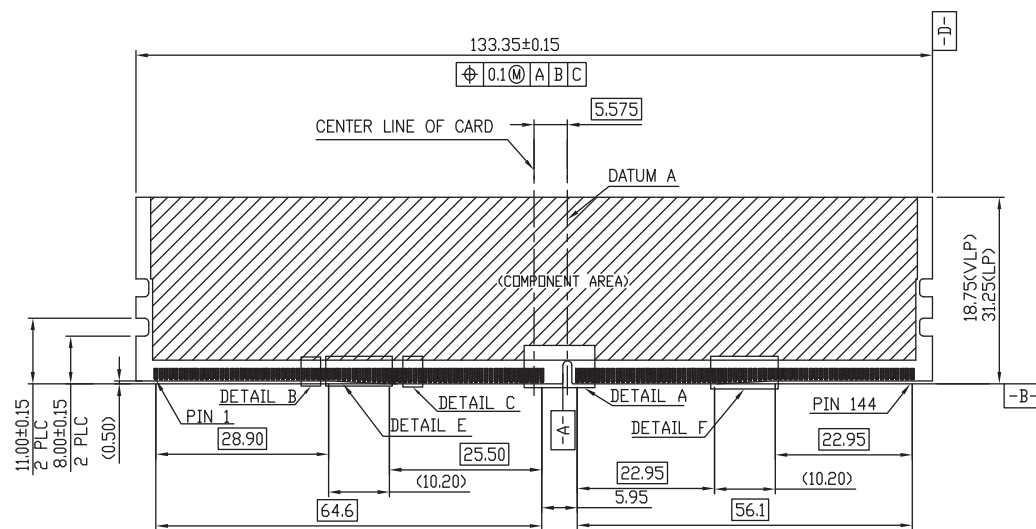

RECOMMENDED MODULE LAYOUT

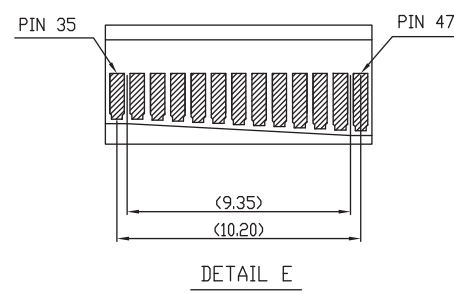
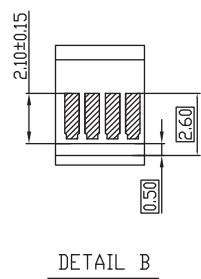
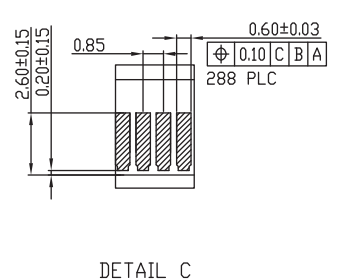

SMP TECHNOLOGY, INC.	
DDR DIMM Socket, Vertical, 288 Position, Thru Hole, 1.2 Volt	
SERIES: B037-288X-03XX-XZHF	Pg: 3 of 3